



INSTALLATION & MAINTENANCE MANUAL

**EMPOWER4 / EMPOWER4W**

## GENERAL INSTRUCTIONS

**These instructions should be read carefully and retained after installation by the end user for future reference and maintenance.**

**These instructions should be used to aid installation of the following products:**

**EMPOWER4 / EMPOWER4W**

## SAFETY

- This product must be installed in accordance with the latest edition of the IEE Wiring Regulations (BS7671) and current Building Regulations. If in any doubt, consult a qualified electrician
- Please isolate mains prior to installation or maintenance
- Check the total load on the circuit (including when this luminaire is fitted) does not exceed the rating of the circuit cable, fuse or circuit breaker
- Please note the IP (Ingress Protection) rating of this product when deciding the location for installation
- Allow 50mm above and around the fitting for air dissipation (do not cover with insulation)
- This product is for indoor use only
- This product is Class II double insulated
- This product is IP20 rated

## INSTALLATION

- Provide power to the required point of installation
- Cut a suitable hole in the mounting surface as per the cut-out details (see Fig. 1) ensuring not to infringe with any joists, gas / water pipes or electrical cables

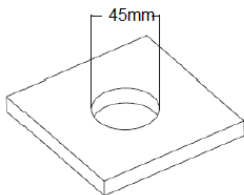

**Fig. 1**

- Connect the luminaire to the mains supply via a suitable junction box (not included) ensuring the correct polarity is observed: LS – Switched Live, L - Live, N - Neutral (see Fig. 2)

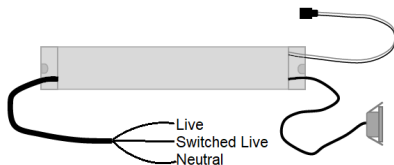

**Fig. 2**

- Connect the battery via the plug and socket to the inverter
- Choose the required bezel and lens according to the light output pattern required (see Fig. 3)

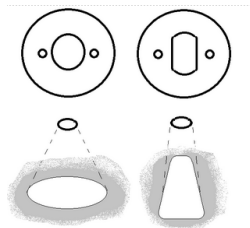

**Fig. 3**

- Remove the bezel and lens by inserting a small flat screwdriver into the edge of the bezel and lift out
- Fit the required lens and bezel, ensuring the two clips on the rear of the bezel are aligned with the slots on the fitting
- Place the battery and inverter into the ceiling void ensuring that there is at least 50mm of clearance above and around them
- Lift both spring clips on the sides of the luminaire and push into the ceiling
- Switch on and check for correct operation, ensuring the green indicator LED is illuminated
- We recommend, on commissioning the installation, a minimum charge period of 24 hours before carrying out an emergency duration test

## WARNING

This product must be disconnected from the circuit if subjected to any high voltage or insulation resistance testing. Irreparable damage will occur if this instruction is not followed.

## GENERAL

The light source of this luminaire is not replaceable; when the light source reaches its end of life the whole luminaire should be replaced.

Clean with a soft dry cloth only, do not use aggressive cleaning products or solvents which may damage the product.

This product is non-dimmable.

This product should be recycled in the correct manner when it reaches the end of its life. Check local authorities for where facilities exist.

The batteries in this luminaire are Lithium Ion and must be disposed of correctly. Please contact the local authorities for the disposal of this toxic waste.

## WARRANTY

This product has a warranty of 5 years from date of purchase. Failure to install this product in accordance with the current edition of the IEE Wiring Regulations (BS7671), improper use, or removal of the batch code will invalidate the warranty. If this product should fail within its warranty period, it should be returned to the place of purchase for a free of charge replacement. ML Accessories does not accept responsibility for any installation costs associated with the replacement product. Your statutory rights are not affected. ML Accessories reserve the right to alter product specification without prior notice.

## TESTING FOR EMERGENCY LUMINAIRES

Recommended routine test procedure in accordance with BS5266

- Daily check – check LED charge indicator is illuminated
- Monthly functional test - simulate a mains supply failure for approx. 30 seconds by operation of key switch or switching off circuit breaker. Ensure normal supply is restored after test and ensure charge indicator is illuminated
- Annual 3-hour duration test - simulate a mains supply failure for 3-hour continuous test by operation of key switch or switching off circuit breaker. Ensure normal supply is restored after test and ensure charge indicator is illuminated
- If the luminaire fails any of the above tests, please contact a qualified electrician. See below for test record sheet



**SUPPLIED BY:**

**(UK) MANUFACTURER**  
**ML ACCESSORIES LTD,**  
UNIT E CHILTERN PARK,  
BOSCOMBE ROAD, DUNSTABLE  
LU5 4LT,  
[WWW.MLACCESSORIES.CO.UK](http://WWW.MLACCESSORIES.CO.UK)

**(EU) AUTHORISED REPRESENTATIVE**  
**SLV LIGHTING GROUP,**  
DAILMERSTRASSE 21-23,  
52531 ÜBACH-PALENBERG, GERMANY  
**EMAIL:** [EPREL@GROUP.SLV.COM](mailto:EPREL@GROUP.SLV.COM)

**TEST RECORD SHEET**

INITIAL COMMISSIONING 3 HOUR TEST		SIGNED				DATE					
		FIRST YEAR		SECOND YEAR		THIRD YEAR		FOURTH YEAR		FIFTH YEAR	
MONTH	TEST	SIGNED	DATE	SIGNED	DATE	SIGNED	DATE	SIGNED	DATE	SIGNED	DATE
1	FUNCTIONAL										
2	FUNCTIONAL										
3	FUNCTIONAL										
4	FUNCTIONAL										
5	FUNCTIONAL										
6	FUNCTIONAL										
7	FUNCTIONAL										
8	FUNCTIONAL										
9	FUNCTIONAL										
10	FUNCTIONAL										
11	FUNCTIONAL										
12	3 HOUR										

Installed by:

Installation date:

Contact number: