



INTELLIGENT FACILITY SOLUTIONS

Electric Works, 3 Concourse Way, Sheffield, S1 2BJ

United Kingdom: +44 (0) 114 354 0047

Eire: +353 190 36387

sales@ihdryers.co.uk

www.intelligenthanddryers.com



TEMPESTA 

Model: TEMPESTA

900W Automatic Hand Dryer



Operation Manual

Note: These instructions must be read fully before commencing use of the Tempesta 900W Automatic Hand Dryer.

Please retain these instructions for future reference.

FOR INDOOR USE ONLY

IMPORTANT SAFEGUARDS

Before use, please read and follow these instructions carefully, even if you feel you are familiar with the product. They contain important information concerning the operation, safety and maintenance when using the product. Please retain these instructions for future use and reference.

- When first installed you may experience a burning smell or a little smoke, this is normal and will fade within a few minutes.
- Only connect the product if the voltage indicated on the product label(s) corresponds with the mains voltage.
- Before use, make sure the rated voltage of this product is the same as your local voltage.
- The automatic hand dryer must not be located directly below a wall socket.
- The hand dryer should not be installed in such a place that it cannot be touched during a bath or shower.
- When cleaning, use a clean damp cloth. Do not use cleaning chemicals.
- Do not use the product in areas where petrol, paint or flammable liquids are used or stored.
- If the power cord is damaged it must be replaced by a service agent or a equivalent qualified electrician. Do not continue to use until repaired, as it may cause a hazard.
- This appliance is not intended to be used by young children or disabled persons unless they have been adequately supervised by a responsible adult to ensure the appliance is used correctly and safely.
- Young children should be supervised to ensure they do not play with the product.
- This appliance is intended for use indoor only.
- Never use the automatic hand dryer to dry clothing or similar items. Do not attempt to dry hair with hand dryer.
- Ensure the automatic hand dryer is installed so that the switches and other controls cannot be touched by a person in the bath or shower.
- Ensure the appliance is securely fixed to the wall and is correctly positioned level. The appliance should be placed no less than 150mm from a barrier/wall on all sides - top, bottom, left and right.
- Do not spray water directly on the product.
- Do not clog the inlet and outlet of air.
- Do not shake the hand dryer violently on installation.

FEATURES

Thank you for purchasing the Tempesta Automatic Hand Dryer. This smart hand dryer comes equipped with digital circuit control, and infrared auto sensing technologies, which are specially designed for use in hotels, homes, and public places. They feature high efficiency, concentrated air flow, quick drying, and finished in brushed stainless steel.

Energy saving: Unique high-speed motor, low overall power consumption, high efficiency, round nozzle for concentrated air flow, and quick drying process. With less than half the power of an ordinary hand dryer, it can complete the drying process twice as quickly. Specially designed heating element switch allow easy shift between warm air and cold air, making it more energy saving and user friendly.

Safe: This smart hand dryer has multiple protection against excessive temperature, (run) over current, and overtime to prevent accidents.

Comfortable: Low noise, automatic infrared touch-free operation. When hand reaches within 10cm of the nozzle, the hand dryer will automatically detect it and start to blow warm air. It will stop operation after 1 second after removing hands.

Endurable: Enclosed stream-line shell of stainless steel, which offers improved water resistance. Easy to maintain and keep clean.

SPECIFICATION:

Voltage	Power	Frequency	IP Rating
220-240V	900W	50Hz	IP22

PACKAGE:

- Hand dryer x1
- Installation template x1
- Operation manual x1
- Installation package: CIJ 8 x 35mm plug x 4, ST4.8 x 40-C screws
- Tapping screws x4

COMPONENTS:

1. Cover
2. Nozzle
3. Sensor
4. Base

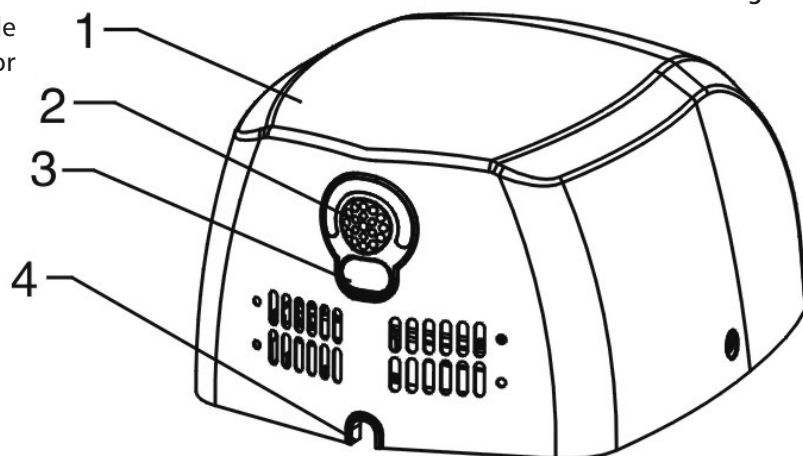
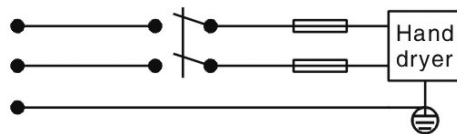

fig. 1

INSTALLATION

- A secondary switch, with contact distance $>3\text{mm}$, shall be installed before connection to the main power.
- This product must be earthed.



1. As showed in Fig. 2, remove screws at both sides of the hand dryer with the supplied Alan key, and take off the shell. Use the installation template provided (Fig. 3) to drill 4 x 8mm holes of 35mm deep.
2. Fix the hand dryer to the wall using the wall plugs and screws provided (Fig. 4)
3. Put on the cover, in the direction as shown in the figure below, to cover the hand dryer. Fix the shell to the base board using screws provided (Fig. 5)
4. In case of concealed installation, knock out the plastic cable cover of wire inlet at the bottom of the back cover, remove the original power cord, thread the wire through the hole and connect in to the corresponding terminals.

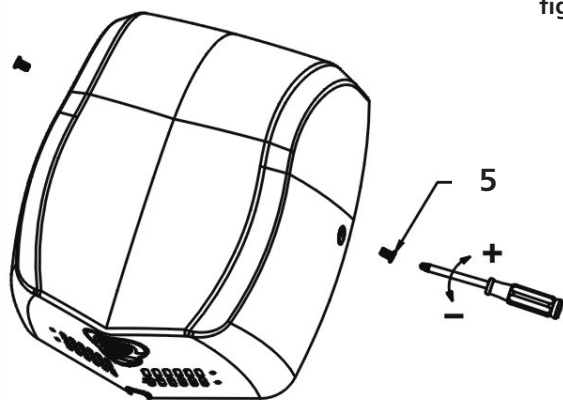

fig. 2

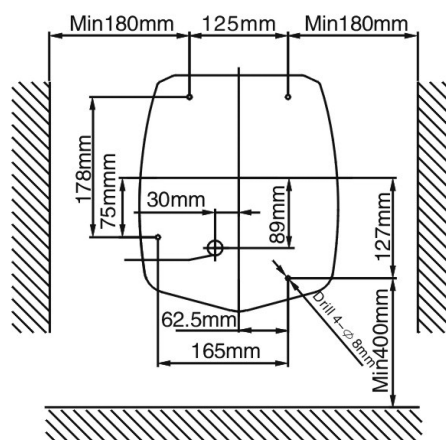

fig. 3

5. Screw

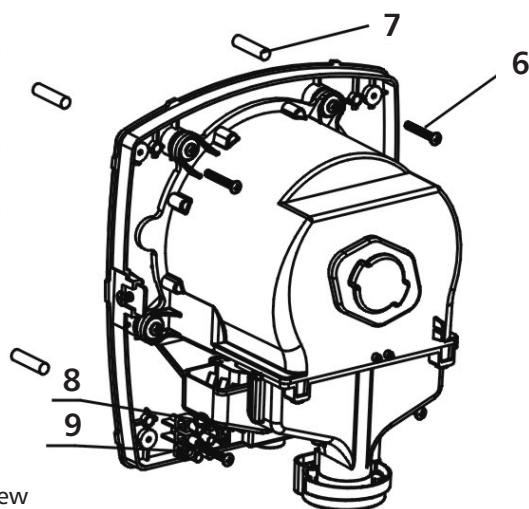

fig. 4

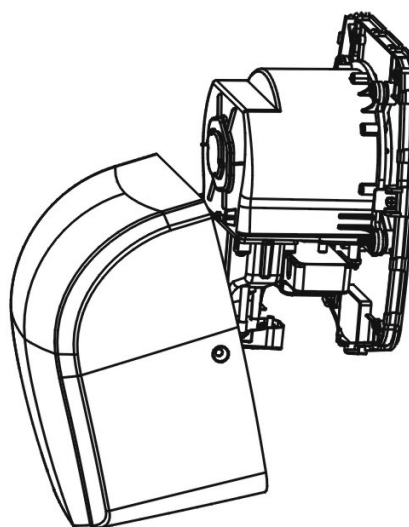

fig. 5

6. Screw
7. Wall plugs
8. Wire terminal
9. Heating element switch

APPLICATION

1. After installation is completed, connect the device to power and it will be stand-by-mode.
2. When you hands reaches within 10cm to the nozzle, the hand dryer will automatically sense it and start to blow warm air. Follow the instructions as showed in Figures 6, 7, and 8 till your hands are dry. It will stop operation after 1 second after you hands move away. If the hand dryer continues to operate for 1 minute, the air flow will stop; it may be restarted when the sensing process is activated again.
3. In order to be operational in various working environments, the infrared transmitter has been set to the highest degree of sensitivity. In the event of prolonged operation or not working, please make adjustment in accordance with Fig. 9.
4. There is an built-in heating element switch; if you want to shift between cold and warm air, take off the shell (Fig. 2), and operate the switch (as showed in Fig. 9) to make the shift (the default setting is warm air).

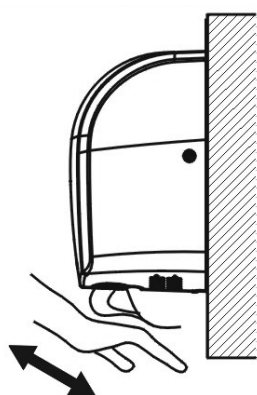

fig. 6

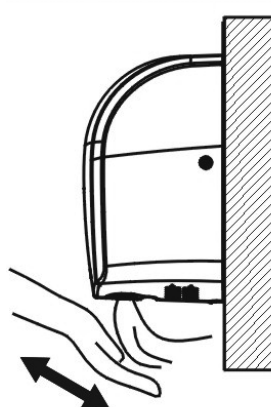

fig. 7

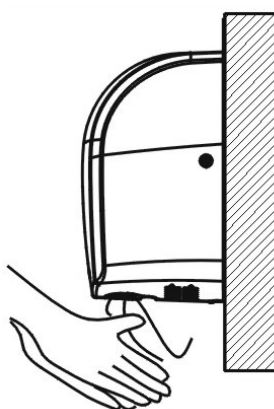

fig. 8

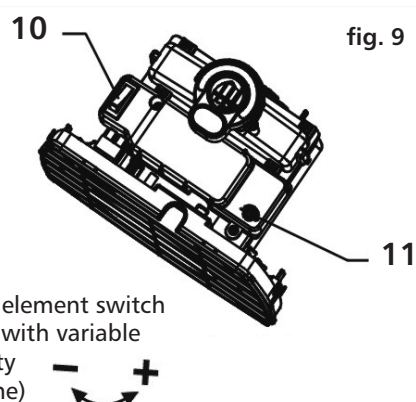
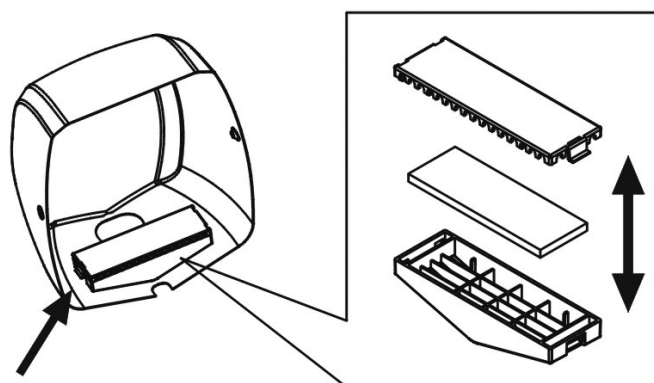

fig. 9

10. Heating element switch
11. Resistor with variable sensitivity (Fine tune)

Change of filter (especially to suit this model, to be purchased separately)

1. Take off the shell, and remove the filter cover at the base as directed by the arrow mark in the diagram.
2. Place the filter into the filter housing and replace back cover.



LIMITED WARRANTY

This product has been made under strictest quality control procedures to ensure good performance and reliability. This product has a warranty against defects in materials and workmanship for 2 years from the date of purchase.

PROVIDED:

1. Reasonable evidence is supplied to prove the product has been purchased within 2 years prior to the date of claim.
2. The defect is not due to misuse, neglect, accidental damage or repair by unqualified engineers.

This warranty does not cover any claims for consequential loss or damage.

These statements do not affect your statutory rights as a customer.

CARE AND CLEANING

Ensure that the automatic hand dryer is unplugged from the mains and is cool before you attempt to clean it. Wipe with a dry cloth to remove dust or with a damp (not wet) cloth to clean stains. Ensure that no moisture gets into the heater.

Do not use abrasive cleaning powder, metal polish or furniture polish on any part of the automatic hand dryer.

CUSTOMER SERVICE

Repairs must be carried out by authorised specialists, thus ensuring electrical safety. Please contact a service agent or a suitably qualified electrician. Improper repairs could lead to danger to the user.

The warranty does not cover damage of failure which results from alteration, accident, misuse, abuse, neglect, commercial use or improper maintenance.

In line with our policy of continuous product development we reserve the right to change the product and documentation specifications without notice.

DISPOSAL

In accordance with European Directive 2002/96/EG concerning waste electrical and electronic equipment (WEEE), please return any electrical equipment that you will no longer use to the collection points provided for their disposal.



This symbol indicates that the appliance cannot be treated as normal domestic waste, but must be handed to a collection point for where electric and electronic appliances are recycled.

Information concerning where the equipment can be disposed of can be obtained from your local authority.

EN 60335-1:2012

1. This appliance can be used by children aged from 8 years and above and persons with reduced physical, sensory or mental capabilities or lack of experience and knowledge if they have been given supervision or instruction concerning use of the appliance in a safe way and understand the hazards involved.
2. Children shall not play with the appliance.
3. Cleaning and user maintenance shall not be made by children without supervision.

EN 60335-2-30:2009+A11

1. Children of less than 3 years should be kept away unless continuously supervised. Children aged from 3 years and less than 8 years shall only switch on/off the appliance provided that it has been placed or installed in its intended normal operating position and they have been given supervision or instruction concerning use of the appliance in a safe way and understand the hazards involved. Children aged from 3 years and less than 8 years shall not plug in, regulate and clean the appliance or perform user maintenance.
2. Some parts of this product can become very hot and cause burns. Particular attention has to be given where children and vulnerable people are present.



NOTES

