



# Installation Instructions

## For Models:

<u>Model Number / Description</u>	<u>File Name</u>
B-155 ClassicSeries® Surface-Mounted LiquidMate® Soap Dispenser	B-150.pdf

# INSTRUCTIONS FOR INSTALLATION AND MAINTENANCE

BOBRICK MODELS B-155 AND B-156 LiquidMate® SOAP DISPENSERS

## Designer's Notes:

These dispensers should be mounted over a sink or lavatory. Provide 1-1/2" (38mm) minimum clearance above container for refilling. The four #8 x 1-1/4" (4.5 x 32mm) screws furnished with unit should be used for mounting unit on most wall surfaces. In some cases, wall anchors will be required (not furnished).

## HOW TO INSTALL DISPENSER:

1. Align the assembled unit vertically.
2. Mark the bottom edge and two bottom mounting holes.
3. Remove the container and realign the bracket with your marks.
4. Mark the two top mounting holes.
5. Predrill mounting holes with 1/16" to 3/32" (1.6–2.4mm) drill bit.
6. Screw bracket into place.
7. Fill container per instructions and return to bracket.

## HOW TO REMOVE AND FILL CONTAINER:

1. Unscrew retaining collar under bracket until container is free.
2. Turn container upright and unscrew liquid valve.
3. Fill container with thin, free-flowing liquid soap or detergent, then reinstall dispenser mechanism. Finger tighten liquid valve onto bracket.
4. Finger tighten retaining collar onto container.

## MAINTENANCE:

Use warm water and mild soap to clean all parts. **NEVER USE ABRASIVE CLEANERS.**

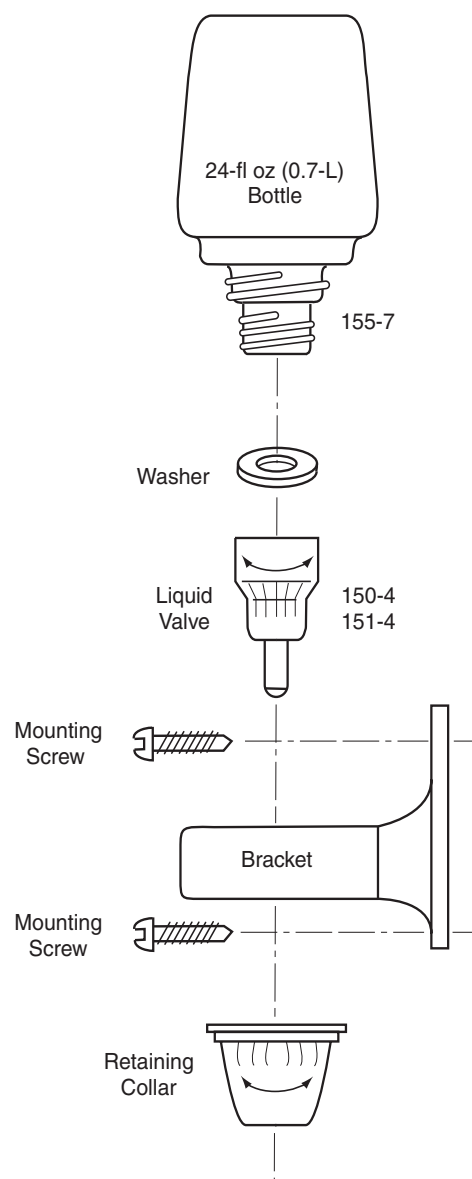

## REPLACEMENT PARTS LIST

Part Name	Part No.
Liquid Valve – Charcoal	150-4
Liquid Valve – Beige	151-4
24-fl oz (0.7-L) Container	155-7

## LiquidMate® Soap Dispensers

