

# Babycare

## BABY CHANGING STATION

### OPERATING INSTRUCTIONS

---

#### IMPORTANT: SAVE THESE INSTRUCTIONS FOR FUTURE REFERENCE



#### WARNING

---

Only a qualified technician can install, adjust and maintain this baby changing station. Any operations performed on the changing station must be compliant with the safety laws and regulations, that are in force at the time.

- It is very important that, once installed and put into operation, the baby changing station is periodically inspected in order to ensure that it remains firmly secured to the wall and it has not suffered any damage that may cause any harm to users. It is very important to make sure that the baby changing station opens and closes properly.
- Any additional component or spare part required for the baby changing station should only be purchased from the manufacturer or from an authorised distributor.
- Do not use the baby changing station if there are indications that any part of it is broken, torn or lost.
- The baby changing station must be secured to a wall capable of withstanding the loads to which it will be subjected daily, and the most appropriate wall fixings must be used for each type of wall.
- The total maximum recommended weight for this changing station is 11 kg and babies up to 12 months according to EN 12221-1:2008+A1:2013 Type 1. The changing station has been tested with a load of 50 kg during 1 hour according to the point 5.7 of the EN 12221-2:2008+A1:2013 Standard. Excessive weight may be dangerous.
- All assembly joints and wall fixings must be properly tightened and inspected regularly.
- It is important to install the changing station away from sources of heat or open fire.
- If the changing station is vandalised, it is very important to remove it from the wall and perform a thorough inspection.
- For better comfort and safety, sanitary liners should always be available in the changing station and the unit should be thoroughly cleaned daily in order to minimize the spread of infectious diseases.
- Under no circumstance should a baby be left unattended on the baby changing station.
- Always place the baby in the centre of the changing station.
- Do not use the changing station when any part is broken, torn or missing.

---

#### IMPORTANT

---

We recommend that the unit be installed to brick, masonry or cement walls. The fixing systems supplied with this changing station are not suitable for installation on plasterboard or hollow walls. In order to install the unit on this type of wall, fastening anchors and tools specific for plasterboard or hollow walls must be used. Due to the problems posed by installations on this type of walls, it is recommended that the installation is carried out by specialised technicians.

Babycare

## PARTS

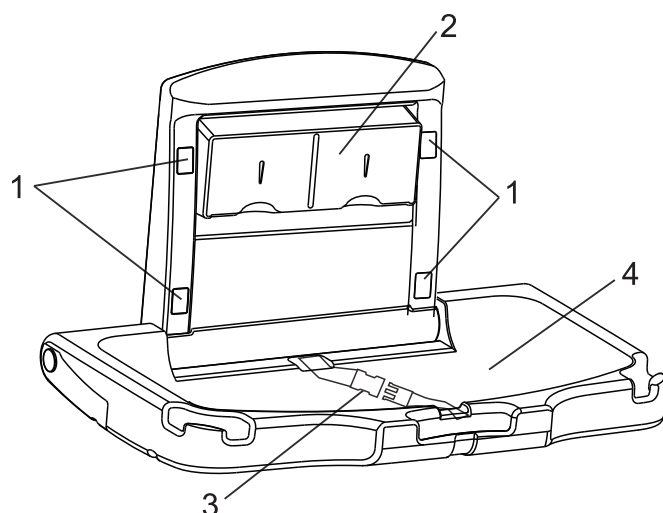

- |                   |                      |
|-------------------|----------------------|
| 1. Mounting holes | 5. 120mm screws      |
| 2. Paper holder   | 6. 100mm screws      |
| 3. Restraint belt | 7. Screw caps (Up)   |
| 4. Table          | 8. Screw caps (Down) |

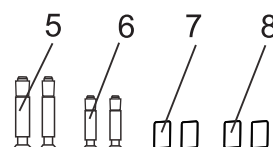

## INSTALLATION INSTRUCTIONS

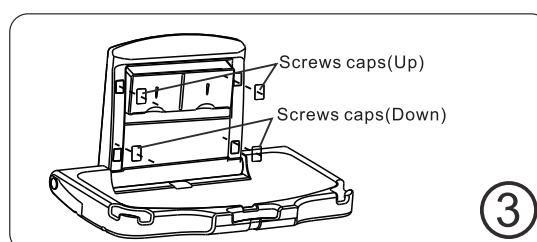
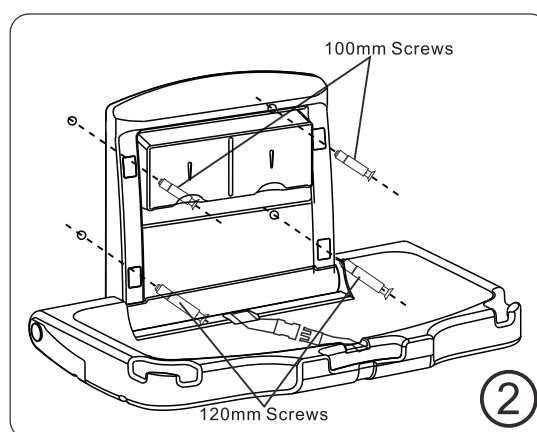
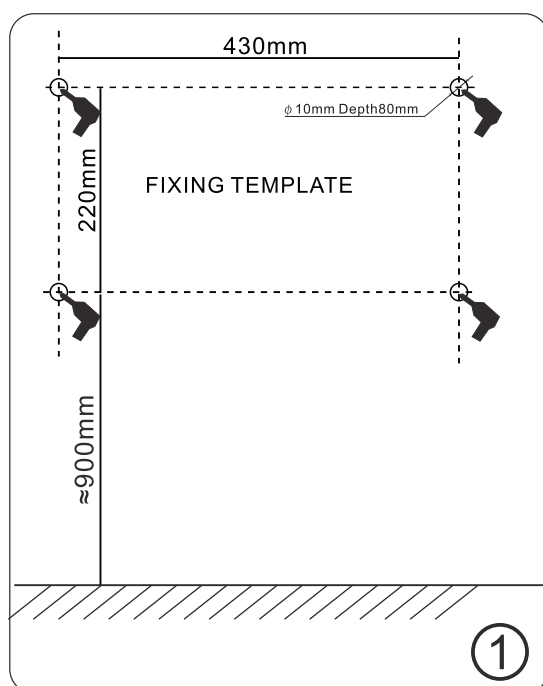

## CLEANING INSTRUCTIONS

The baby changing station can be washed and wiped with a damp soft cloth or sponge. Use of mild detergent and warm water will remove the majority of dust and stains.  
For more difficult stains, a domestic cream cleaner can be used. Do not use any abrasive cloths, caustic or solvent cleaners as these may damage the unit.

## MAINTENANCE INSTRUCTIONS

Open the unit and check that the four wall mounting fixings are secure.  
Ensure warning label is in place on the inside of the unit and the unit is clean.  
Ensure closing mechanism returns the tray to the upright position.  
Any replacement parts must be obtained from authorised distributor.

Babycare